

# 共和镇新连工业区升级改造项目勘测定界图 (GH20654)

鹤山市共和镇新连村委会

单位: m.m<sup>2</sup>

8381.80 2497.53 8382.72 2497.53



点号	X	Y	点号	X	Y	点号	X	Y	点号	X	Y
1	249753.00	838180.00	11	249753.00	838272.00	21	249753.00	838272.00	31	249753.00	838180.00
2	249753.00	838180.00	12	249753.00	838180.00	22	249753.00	838180.00	32	249753.00	838180.00
3	249753.00	838180.00	13	249753.00	838180.00	23	249753.00	838180.00	33	249753.00	838180.00
4	249753.00	838180.00	14	249753.00	838180.00	24	249753.00	838180.00	34	249753.00	838180.00
5	249753.00	838180.00	15	249753.00	838180.00	25	249753.00	838180.00	35	249753.00	838180.00
6	249753.00	838180.00	16	249753.00	838180.00	26	249753.00	838180.00	36	249753.00	838180.00
7	249753.00	838180.00	17	249753.00	838180.00	27	249753.00	838180.00	37	249753.00	838180.00
8	249753.00	838180.00	18	249753.00	838180.00	28	249753.00	838180.00	38	249753.00	838180.00
9	249753.00	838180.00	19	249753.00	838180.00	29	249753.00	838180.00	39	249753.00	838180.00
10	249753.00	838180.00	20	249753.00	838180.00	30	249753.00	838180.00	40	249753.00	838180.00



鹤山市山水测绘有限公司  
2000年大地坐标系: 中央子午线 114度  
1985国家高程基准, 高程单位为米  
证书编号: 内测资字4424251  
证 2007年版式

1:4000

8381.80

2496.25

# 共和镇新连工业区升级改造项勘测定界图 (GH20653)

鹤山市共和镇新连村委会

单位: m.m<sup>2</sup>

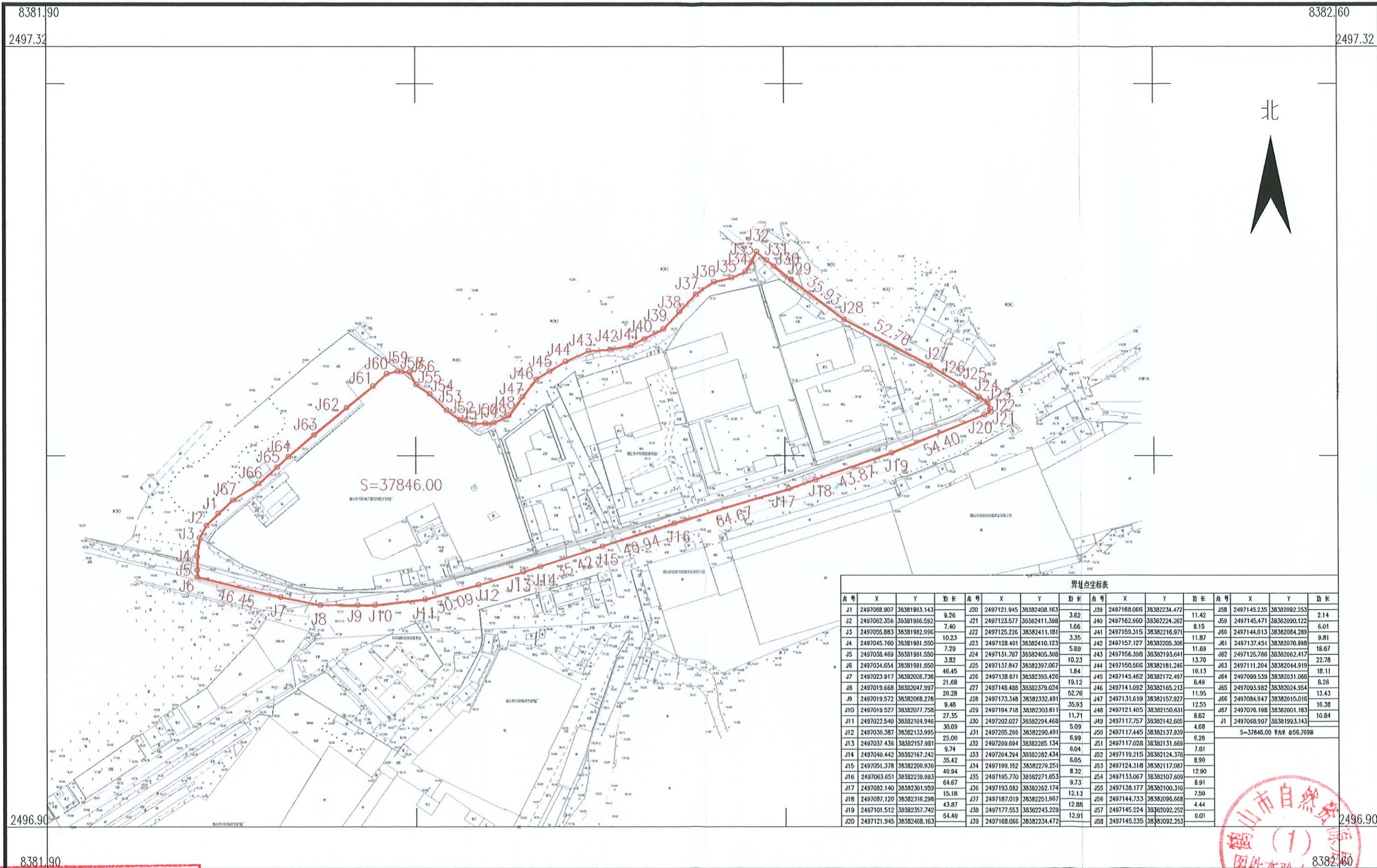

界址点坐标表

点号	X	Y	边长	点号	X	Y	边长	点号	X	Y	边长	点号	X	Y	边长
J1	2497088.907	38381993.143	9.26	J20	2497121.945	38382408.163	3.82	J39	2497168.066	38382234.472	11.42	J58	2497145.235	38382092.253	2.14
J2	2497082.356	38381926.592	7.40	J21	2497123.577	38382411.398	1.66	J40	2497162.960	38382224.262	8.15	J59	2497145.471	38382090.122	6.01
J3	2497055.883	38381982.896	10.23	J22	2497125.226	38382411.181	3.35	J41	2497159.315	38382216.971	11.87	J60	2497144.013	38382084.289	9.81
J4	2497045.760	38381981.550	7.29	J23	2497128.401	38382410.123	5.89	J42	2497157.127	38382205.306	11.69	J61	2497137.451	38382076.998	18.67
J5	2497038.469	38381981.550	3.82	J24	2497131.787	38382405.308	10.23	J43	2497156.398	38382193.641	13.70	J62	2497125.796	38382062.417	22.78
J6	2497034.654	38381981.550	46.45	J25	2497137.847	38382397.067	1.84	J44	2497150.566	38382181.246	19.12	J63	2497111.204	38382044.919	8.49
J7	2497023.917	38382026.736	21.68	J26	2497138.671	38382395.426	52.76	J45	2497145.462	38382172.497	11.95	J64	2497099.539	38382031.068	13.43
J8	2497019.668	38382047.997	20.28	J27	2497148.488	38382379.024	11.71	J46	2497141.092	38382165.213	8.82	J65	2497093.982	38382024.954	10.84
J9	2497019.572	38382068.278	9.48	J28	2497173.348	38382332.491	35.93	J47	2497131.619	38382157.927	4.68	J66	2497084.947	38382015.016	6.26
J10	2497019.527	38382077.758	27.35	J29	2497194.718	38382303.611	5.09	J48	2497121.405	38382150.631	6.26	J67	2497076.198	38382001.163	8.26
J11	2497022.540	38382104.946	30.09	J30	2497202.027	38382294.468	6.99	J49	2497117.757	38382142.605	7.61	J1	2497068.907	38381993.143	10.84
J12	2497030.387	38382133.995	25.00	J31	2497205.206	38382290.491	6.04	J50	2497117.445	38382137.839	8.90	S=37846.00 面积 656.769亩			
J13	2497037.436	38382157.981	9.74	J32	2497209.094	38382285.134	6.05	J51	2497117.028	38382131.669	12.90				
J14	2497040.442	38382167.242	35.42	J33	2497204.294	38382282.434	8.32	J52	2497119.215	38382124.378	8.91				
J15	2497051.378	38382200.936	40.94	J34	2497199.152	38382279.251	9.73	J53	2497124.318	38382117.087	7.50				
J16	2497063.651	38382239.993	64.67	J35	2497195.770	38382271.653	12.88	J54	2497133.067	38382107.609	4.44				
J17	2497082.140	38382301.959	15.18	J36	2497193.682	38382262.174	12.91	J55	2497138.177	38382100.310	0.01				
J18	2497087.120	38382316.298	43.87	J37	2497187.019	38382251.967		J56	2497144.733	38382096.668					
J19	2497101.512	38382357.742	54.40	J38	2497177.553	38382243.229		J57	2497145.224	38382092.252					
J20	2497121.945	38382408.163		J39	2497168.066	38382234.472		J58	2497145.235	38382092.253					

鹤山市山水测绘有限公司

鹤山市山水测绘有限公司  
2020年9月数字化制图  
2000国家大地坐标系, 中央子午线114度  
1985国家高程基准, 等高距为1米  
证书编号: 内测资字1121251  
2007年版式

1:2000

鹤山市自然资源局  
图件直验专用章  
绘图员: 薛翔  
检查员: 周军  
审核员: 周泳锋